

### Student Parking

- SP2 SP7
- SP3 SP8
- SP4 SP9
- SP5 SP10
- SP6

### Faculty/Staff Parking

- FP1 FP2

### Visitor Parking

Reserved for Non-Students  
7 a.m.-4:30 p.m. weekdays.  
VP1 VP2 VP3  
When visitor lots are full,  
visitors may park in student  
spaces. Visitors must display a  
Visitor's Parking Permit which is  
available at the Campus Security/  
Information Office.

### Handicapped Parking Available In All Lots

### Sculptures

- 1** New Heritage Sculpture  
by Hillis Arnold
- 2** Quandary  
by John Edgcomb
- 3** Spirit of Survival  
by Ruth Duckworth
- 4** Sacagawea  
by Glenna Goodacre
- 5** North Point  
by Michael Dunbar
- 6** Crossroads  
by Richard Hunt
- 7** Bloom  
by John Medwedeff

### Gardens

- A** River of Colors
- B** The Overlook
- C** The Grove
- D** Fountain Court

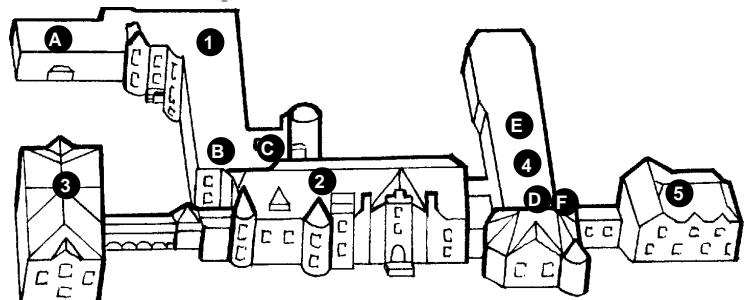

### Main Complex

1. Baldwin Hall
  - A. Enrollment Center
  - B. Bookstore
  - C. ATM
2. Caldwell Hall
3. Fobes Hall
4. Reid Hall
  - D. Reid Memorial Library
  - E. 1st floor-Restaurant
  - 2nd floor - Learning Resource Center (LRC)
  - F. 1st floor - TDD Phone
5. Wade Hall

Open Parking After 4:30 p.m.